

Plastic Ball Knobs

- ▶ Black thermoplastic ball knob
- ▶ High polished finish
- ▶ Internal thread



PART #	X Thread	Depth	INCH		
			A	B	C
PB-5	#10-32	5/16	25/32	47/64	3/8
PB-9	1/4-20	7/16	1	29/32	1/2
PB-10	5/16-18	7/16	1	29/32	1/2
PB-11	3/8-16	1/2	1-3/8	1-3/16	5/8
PB-13	1/2-13	5/8	1-7/8	1-1/2	3/4
PB-15	1/2-13	3/4	2	1-27/32	1-1/16

PART #	X Thread	METRIC		
		A	B	C
PB-20	M4 x .7	16mm	8mm	8mm
PB-21	M5 x .8	20	10.5	12
PB-22	M6 x 1.0	25	13.5	15
PB-23	M8 x 1.25	32	16	16
PB-24	M10 x 1.5	36	21	18
PB-25	M12 x 1.75	40	25	22

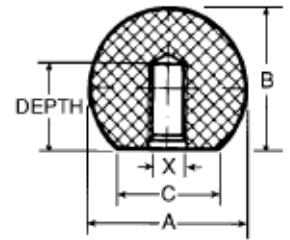

Steel and Brass Ball Knobs

- ▶ Machined from bar stock
- ▶ High polished decorative finish



STEEL BALL KNOBS			
PART #	X Thread	A	B
SK-31	#10-24	3/4	3/8
SK-32	#10-32	3/4	3/8
SK-35	1/4-20	1	1/2
SK-39	1/4-20	1-3/8	5/8
SK-37	5/16-18	1	1/2
SK-42	5/16-18	1-3/8	5/8
SK-44	3/8-16	1-3/8	5/8
SK-49	3/8-16	1-7/8	3/4
SK-47	1/2-13	1-3/8	5/8
SK-52	1/2-13	1-7/8	3/4
SK-54	5/8-11	1-7/8	3/4

BRASS BALL KNOBS			
PART #	X Thread	A	B
BK-31	#10-24	3/4	3/8
BK-32	#10-32	3/4	3/8
BK-35	1/4-20	1	1/2
BK-39	1/4-20	1-3/8	5/8
BK-37	5/16-18	1	1/2
BK-42	5/16-18	1-3/8	5/8
BK-44	3/8-16	1-3/8	5/8
BK-49	3/8-16	1-7/8	3/4
BK-47	1/2-13	1-3/8	5/8
BK-52	1/2-13	1-7/8	3/4
BK-54	5/8-11	1-7/8	3/4

